



# **Performance Oil Catch Can Kit**

## **Part Number: 860-032**

**2024-2026 Toyota Tacoma 2.4L Turbo**  
**(Fits Gas and Hybrid models)**

## **Installation Instructions**

For technical inquiries, please email us at [tech@hpsperformance.com](mailto:tech@hpsperformance.com)

In the email, please include the following information for faster response:

- Year / Make / Model / Engine of your vehicle
- If it is a fitment issue, please include pictures showing the fitment problem
- If there are missing parts, please list the part number(s) from the bill of materials on the 2nd page
- Optional but recommended – Your contact phone number and preferred call back time

You can also give us a call via 626-747-9200 for tech support Monday-Friday, 9:00am-4:30pm Pacific Time.

# Bill of Materials

## Kit Number: 860-032

Line #	Description	Part Number	Qty
1	Oil Catch Can	OCC-14	1
2	Oil Catch Can Bracket	OCC-BRKT-040	1
3	Straight Aluminum Adapter, AN-10 to 16mm x 1.50	AN816-10-M1615	2
4	Push-On Aluminum Hose End, AN-10	150-0010	2
6	Inlet Hose Assembly	HOSE-86-105	1
7	Outlet Hose Assembly	HOSE-86-106	1
8	Embossed Hose Clamp, 20mm - 32mm	EMSC-20-32	1
9	M6 Flat Washer 16mm OD	HW-FW6L	3
10	Stainless Steel Bolt Button Head M5 x 0.8 x 10	HW-B5-10	3
11	Aluminum Unthreaded Spacer, 16mm OD, 13mm Long, 8mm ID	HW-FS-M8-13	1
12	Bolt, M6 x 1.0, 16mm Long	HW-B6-16	2
13	Bolt, M6 x 1.0, 30mm Long	HW-B6-30	1

- **Before installing any parts of this oil catch can kit, please read the instructions thoroughly.**
- **Verify the contents of this oil catch can kit before disassembling your vehicle.**
- **DO NOT INSTALL IF ANY PARTS ARE MISSING OR DAMAGED. CONTACT [tech@hpsperformance.com](mailto:tech@hpsperformance.com) IMMEDIATELY. WE ARE NOT RESPONSIBLE FOR ANY DAMAGE CAUSED DUE TO IMPROPER INSTALLATION.**
- **Installation requires moderate mechanical skills. A qualified mechanic is highly recommended.**
- **Do not attempt to install the catch can while the engine is hot.**
- **This installation may require removal of coolant lines that may be hot.**
- **For technical inquiries, please email us at [tech@hpsperformance.com](mailto:tech@hpsperformance.com)**

## **PLEASE READ CAREFULLY BEFORE INSTALLATION!**

This installation is not for the novice customer. Install this product with EXTREME caution! Misuse of this product can destroy your engine! If you are not mechanically inclined, please have a professional automotive mechanic install this kit.

***NOTE: HPS holds no responsibility for any engine damage that results from misuse of this product.***

## **GETTING STARTED**

1. Turn the ignition OFF and disconnect the vehicle's negative battery cable. If the engine has run within the past two hours let it cool down.

NOTE: Disconnecting the negative battery cable erases pre-programmed electronic memories. Write down all memory settings before disconnecting the negative battery cable. Some radios will require an anti-theft code to be entered after the battery is reconnected. The anti-theft code is typically supplied with your owner's manual. In the event your vehicle's anti-theft code cannot be recovered, contact an authorized dealership to obtain your vehicle's anti-theft code. We also highly recommend NOT discarding any stock parts after the installation.

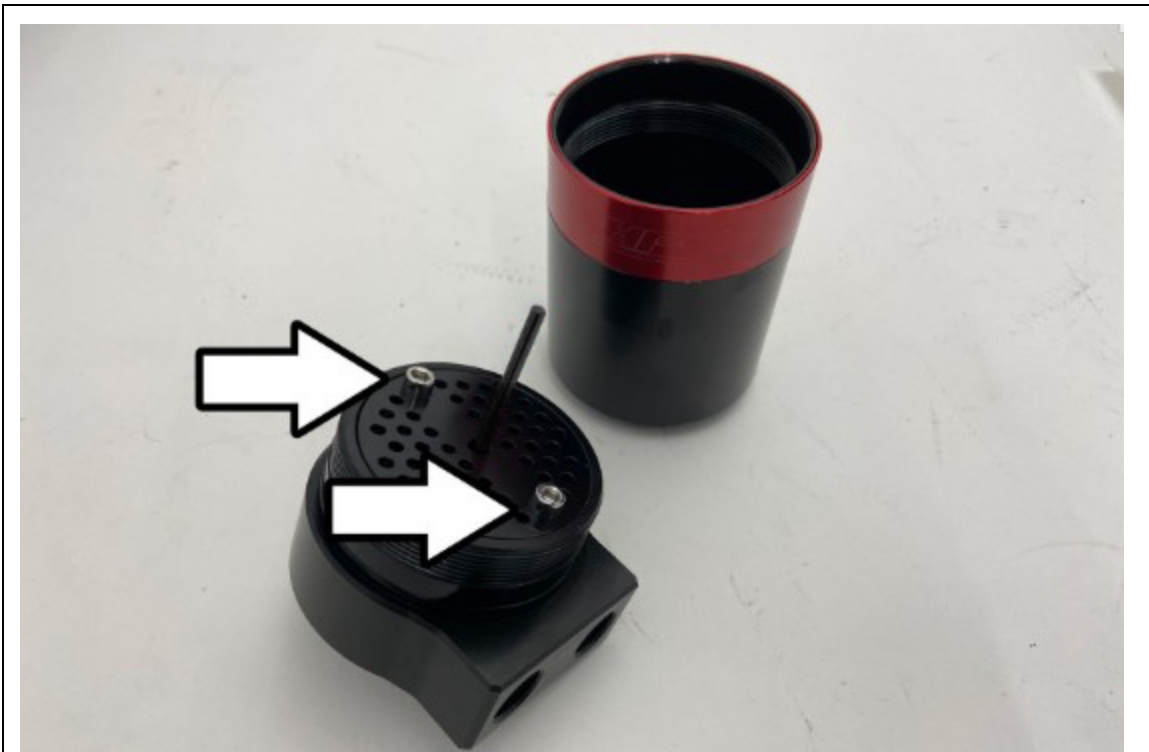

2. Unscrew the top of the HPS oil catch can and check that the Allen bolts are tight.

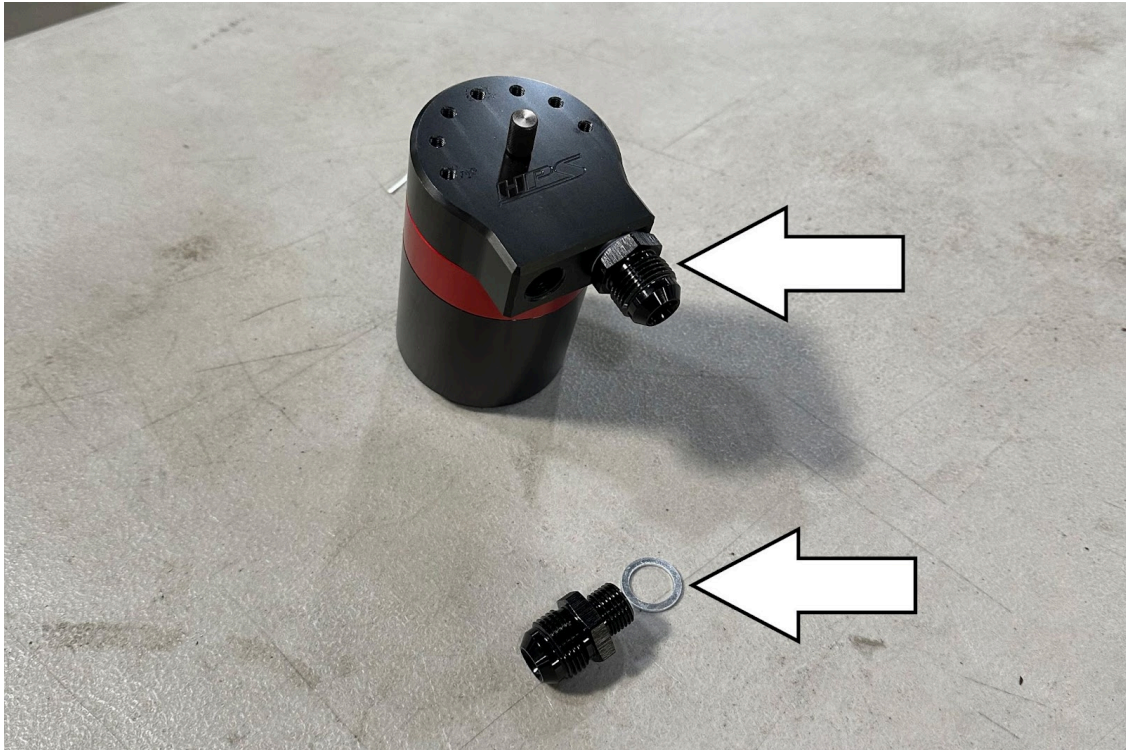

3. Place the provided crush washers onto the metric side of the two AN-10 to M16 x 1.5 adapters and install them onto the oil catch.

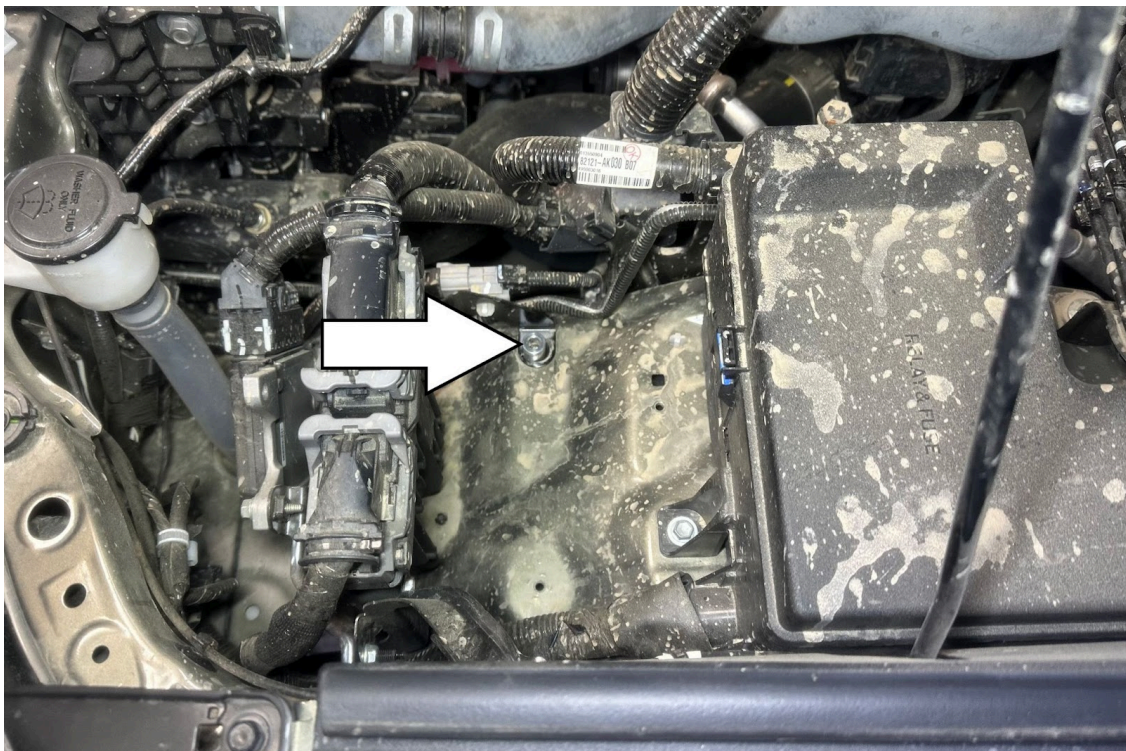

4. Remove the mounting bolt for the bracket shown above. Place the spacer on top of that bracket.

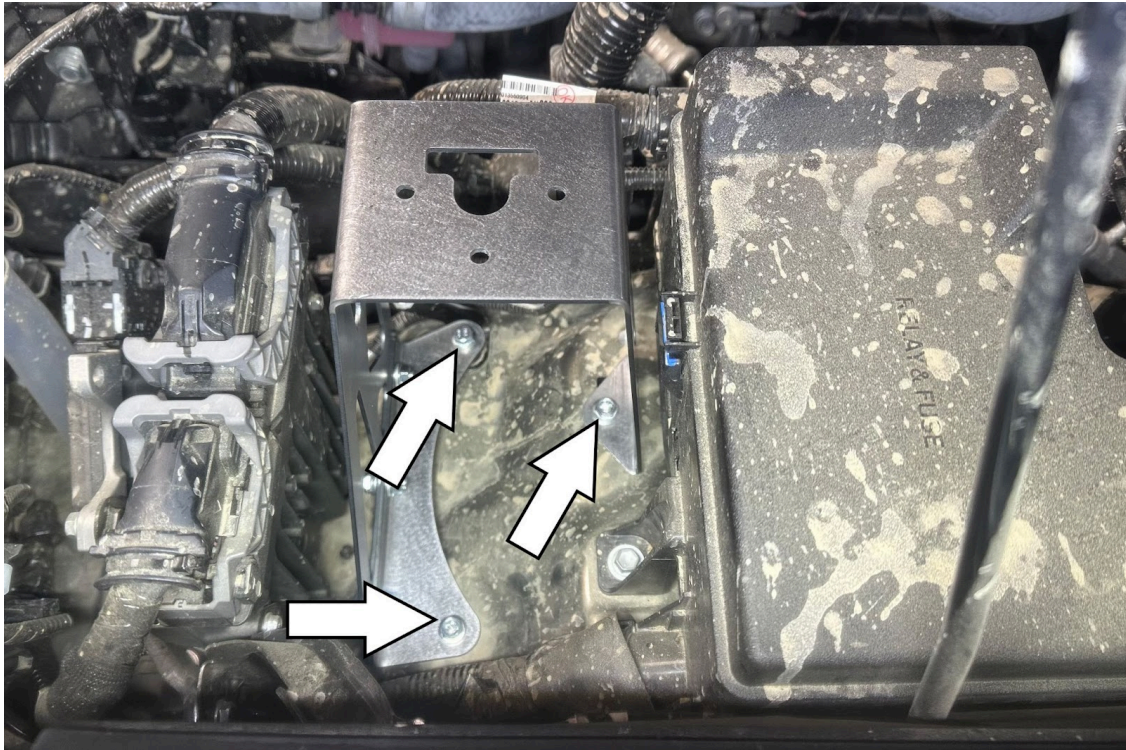

5. Place the oil catch can bracket onto the mounting points indicated. First, use the 30mm long M6 bolt and washer to secure the mounting point with the spacer on it. Install the two 16mm long M6 bolts and washers onto the remaining mounting points.

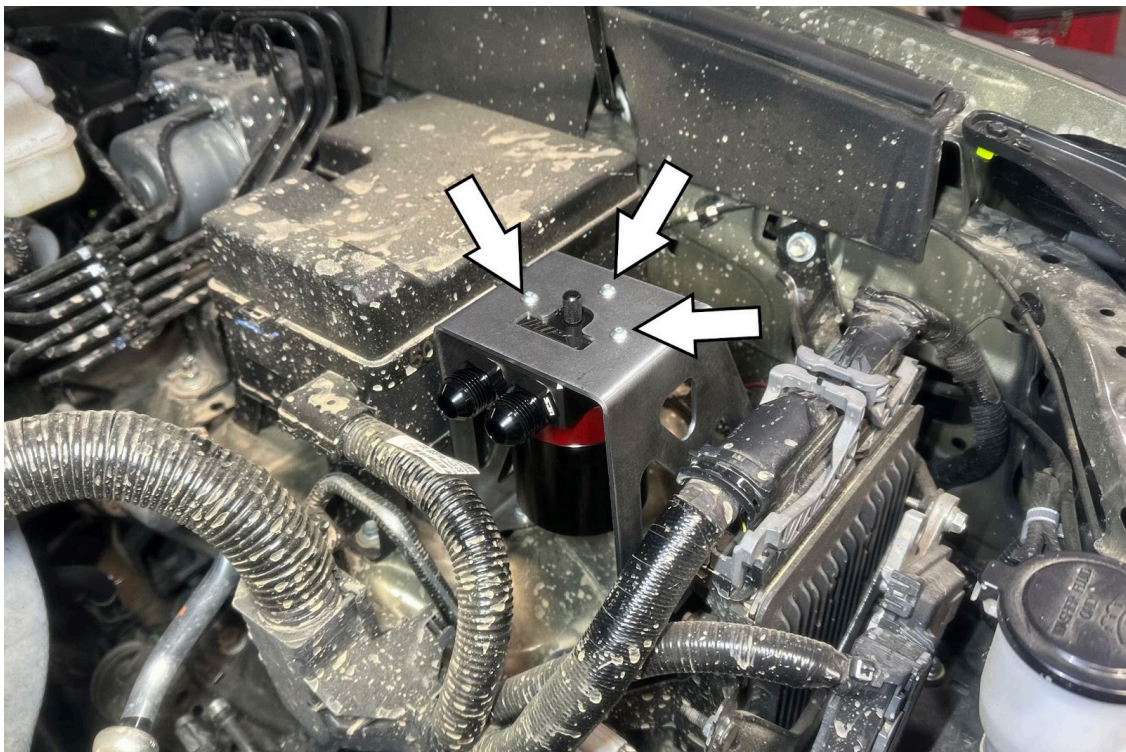

6. Mount the oil catch can onto the bracket using the three provided M5 button head bolts.

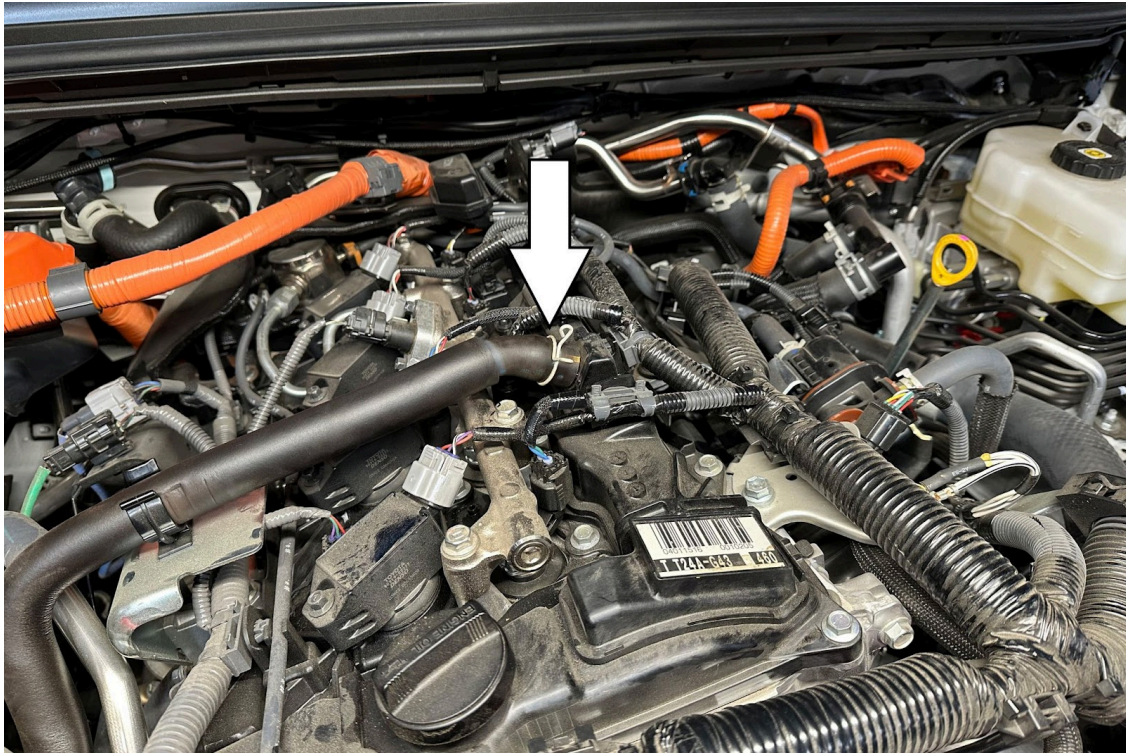

7. Disconnect the ventilation hose located at top of the engine.

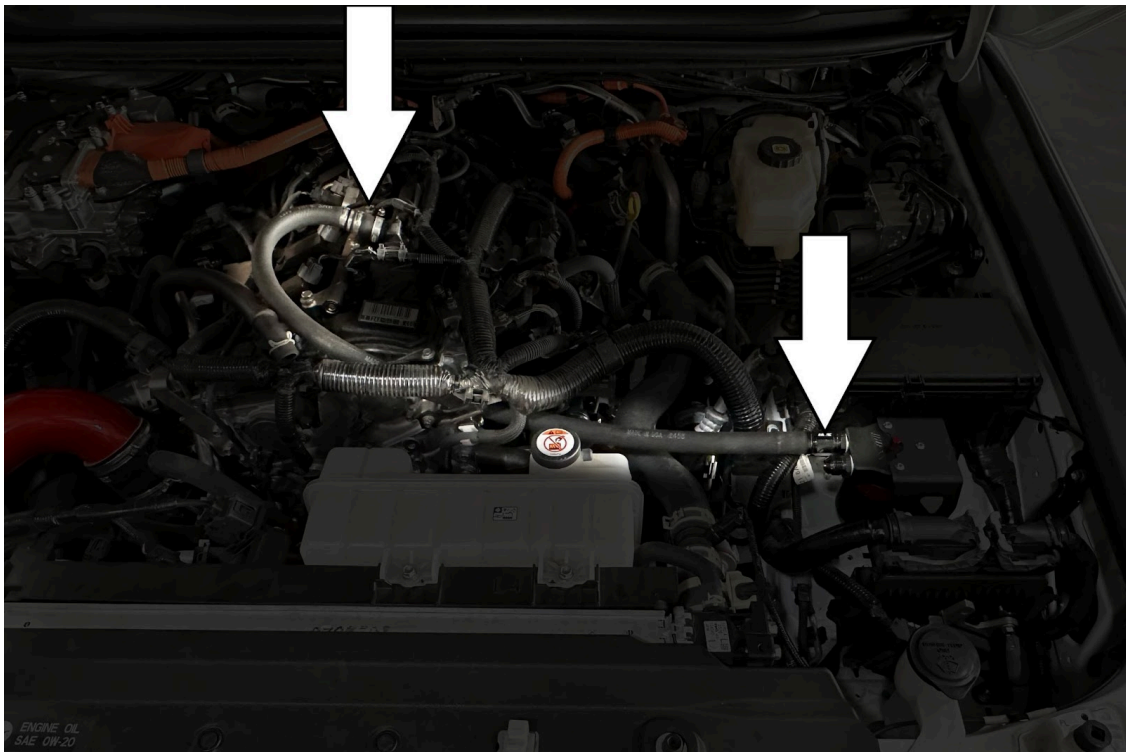

8. Install the pre-assembled 33-inch long hose from the valve cover to the oil catch can. Use the provided embossed hose clamp to secure the hose at the valve cover.

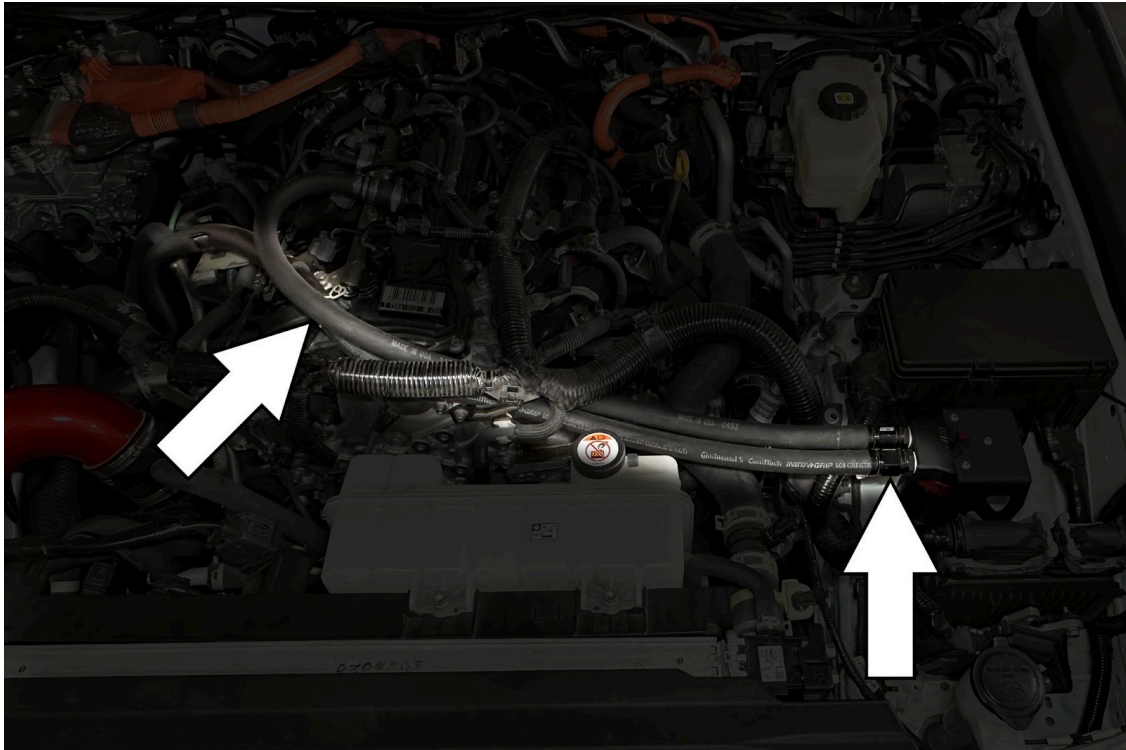

9. Reusing the factory clamp, secure the pre-assembled 23.5-inch long hose to the stock ventilation hose disconnected in step 7. Install the other end of the hose to the oil catch can.

## **FINAL STEPS**

Upon completion of the installation, reconnect the negative battery terminal before you start the engine. Double check to make sure everything is tight and properly positioned before starting the vehicle.

Start the engine. Let the car idle for 3 minutes. Perform a final inspection before driving. Listen carefully for any odd noises or rattles prior to taking it for a test drive. If any problems arise, go back and check the hoses and clamps that may be causing the issue and correct the problem.

Ensure that the dipstick on the HPS oil catch can is fully seated. Failure to install the dipstick properly will result in a check engine light and poor performance.



**Also available for:  
2024-2026 Toyota Tacoma 2.4L Turbo**



**HPS Performance Air Intake Kit**  
Part Number [827-779](#)



**HPS Silicone Air Intake Hose Kit**  
Part Number [57-2207](#)



**HPS Stainless Steel Magnetic Oil Drain Plug**  
Part Number [MDP-M12x125](#)

Contact an authorized HPS Performance dealer or  
visit us at [hpsperformance.com](https://www.hpsperformance.com) for more details