



Performance Oil Catch Can Kit

Part Number: 860-019

Lexus 2003-2009 GX470 4.7L V8

Installation Instructions

For technical inquiries please email us at tech@hpsperformance.com

In the email, please include the following information for faster response:

- Year / Make / Model / Engine of your vehicle
- If it is a fitment issue, please include pictures showing the fitment problem
- If there are missing parts, please list the part number(s) from the bill of materials on the 2nd page
- Optional but recommended – Your contact phone number and preferred call back time

You can also give us a call via 626-747-9200 for tech support Monday-Friday, 9:00am-5:00pm Pacific Time.

Bill of Materials

Kit Number: 860-019

Line #	Description	Part Number	Qty
1	Oil Catch Can	OCC-14	1
2	Oil Catch Can Bracket	OCC-BRKT-014	1
3	Bolt, M8 x 1.25, 16mm Long	HW-B8-16	2
4	Bolt, M5 x 0.8, 10mm Long	HW-B5-10	3
5	Flat Washer, M8, 16mm OD	HW-FW8S	2
6	Straight Aluminum Adapter, AN-6 to 16mm x 1.50	AN816-6-M1615	2
7	Push-On Aluminum Hose End, AN-6, 90 Degree	150-9006	2
8	150 Series Push-On Hose, AN-6	150-06	22 inches
9	150 Series Push-On Hose, AN-6	150-06	37 inches

- **Before installing any parts of this oil catch can kit, please read the instructions thoroughly.**
- **Verify the contents of this oil catch can kit before disassembling your vehicle.**
- **Report any defective or missing parts to HPS directly. The HPS dealer you purchased this product from might not have the replacement parts you need.**
- **Installation requires moderate mechanical skills. A qualified mechanic is highly recommended.**
- **Do not attempt to install the oil catch can kit while the engine is hot.**
- **This installation may require the removal of coolant lines that may be hot.**
- **For technical inquiries, please email us at tech@hpsperformance.com**

PLEASE READ CAREFULLY BEFORE INSTALLATION!

This installation is not for the novice customer. Install this product with EXTREME caution! Misuse of this product can destroy your engine! If you are not mechanically inclined, please have a professional automotive mechanic install this kit.

NOTE: HPS holds no responsibility for any engine damage that results from misuse of this product.

GETTING STARTED

1. Turn the ignition OFF and disconnect the vehicle's negative battery cable. If the engine has run within the past two hours let it cool down.

NOTE: Disconnecting the negative battery cable erases pre-programmed electronic memories. Write down all memory settings before disconnecting the negative battery cable. Some radios will require an anti-theft code to be entered after the battery is reconnected. The anti-theft code is typically supplied with your owner's manual. In the event your vehicle's anti-theft code cannot be recovered, contact an authorized dealership to obtain your vehicle's anti-theft code. We also highly recommend NOT discarding any stock parts after the installation.



2. Remove the two bolts to remove the engine cover from the vehicle.

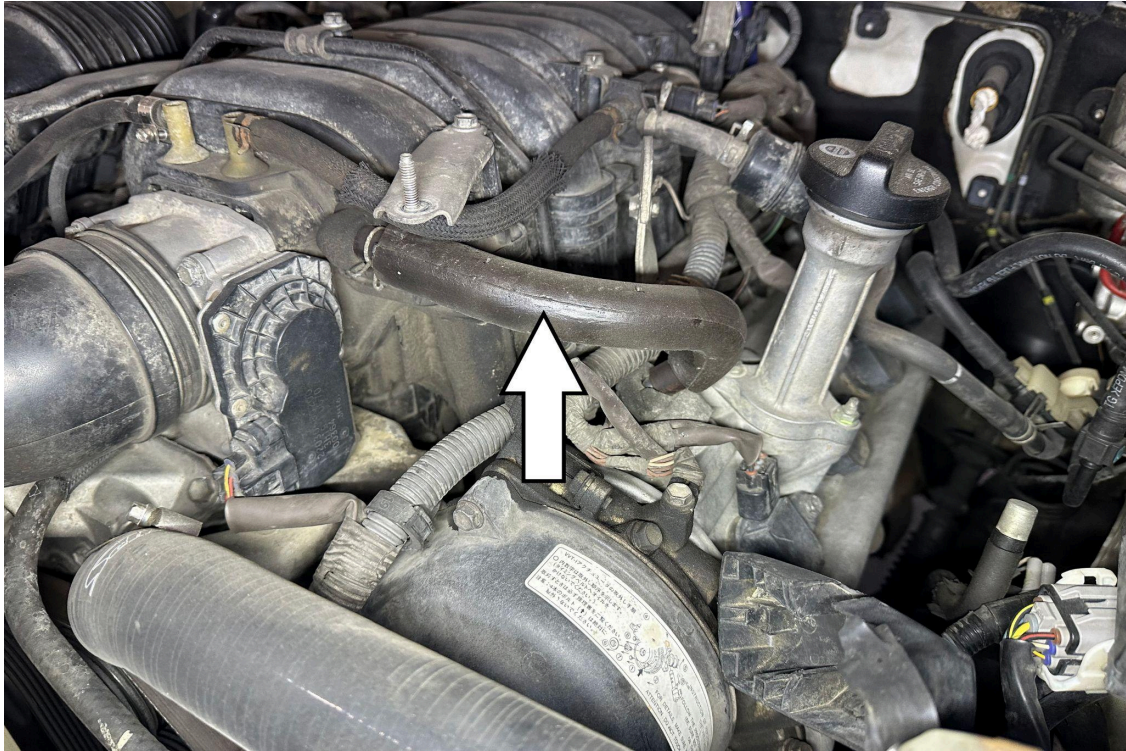

3. Remove the original PCV hose from the engine.

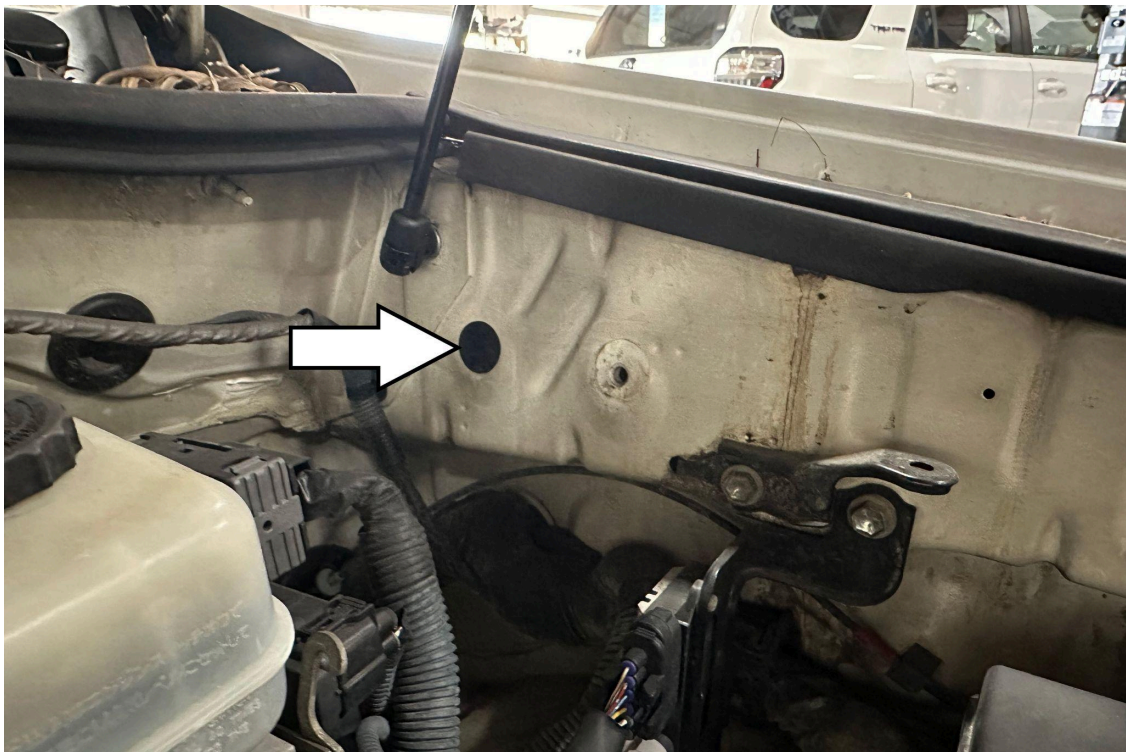

4. Remove the sticker from the inner fender.



5. Secure the oil catch can mounting bracket to the inner fender by using two of each provided M8 washers and bolts.

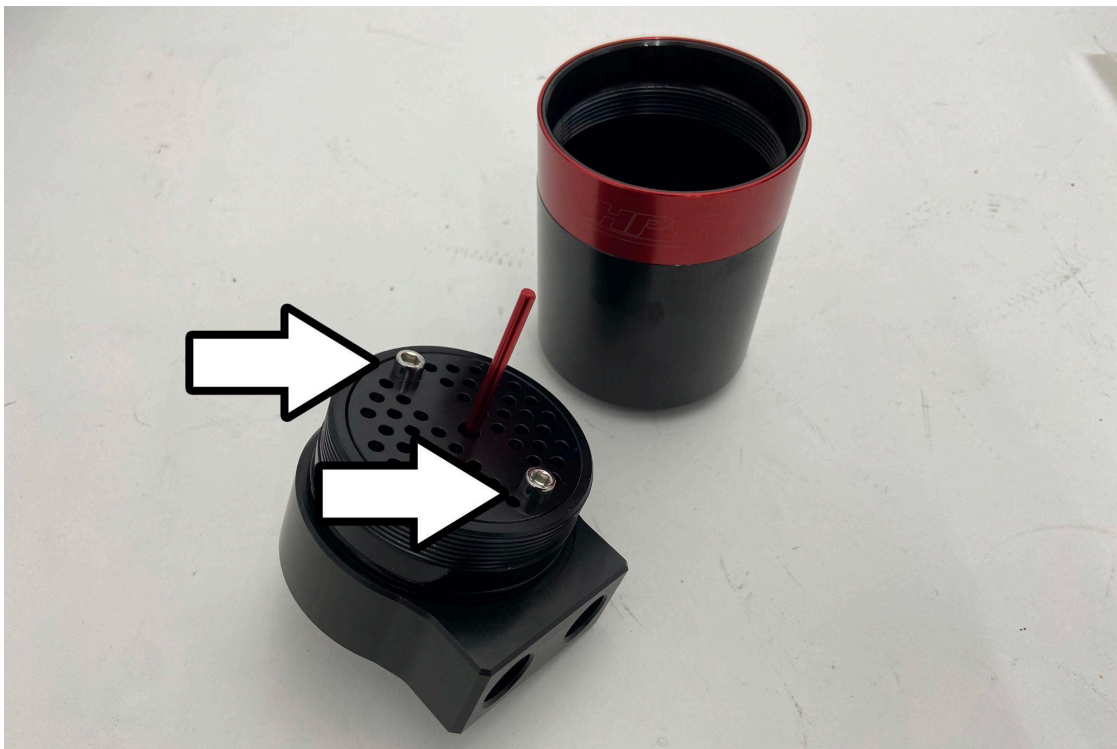

6. Unscrew the top of the HPS Oil Catch Can and check that the Allen bolts are tight.



7. Slide the provided crush washers onto the metric side of the provided AN to M16 adapter fittings. Then fasten the adapters securely onto the oil catch can.

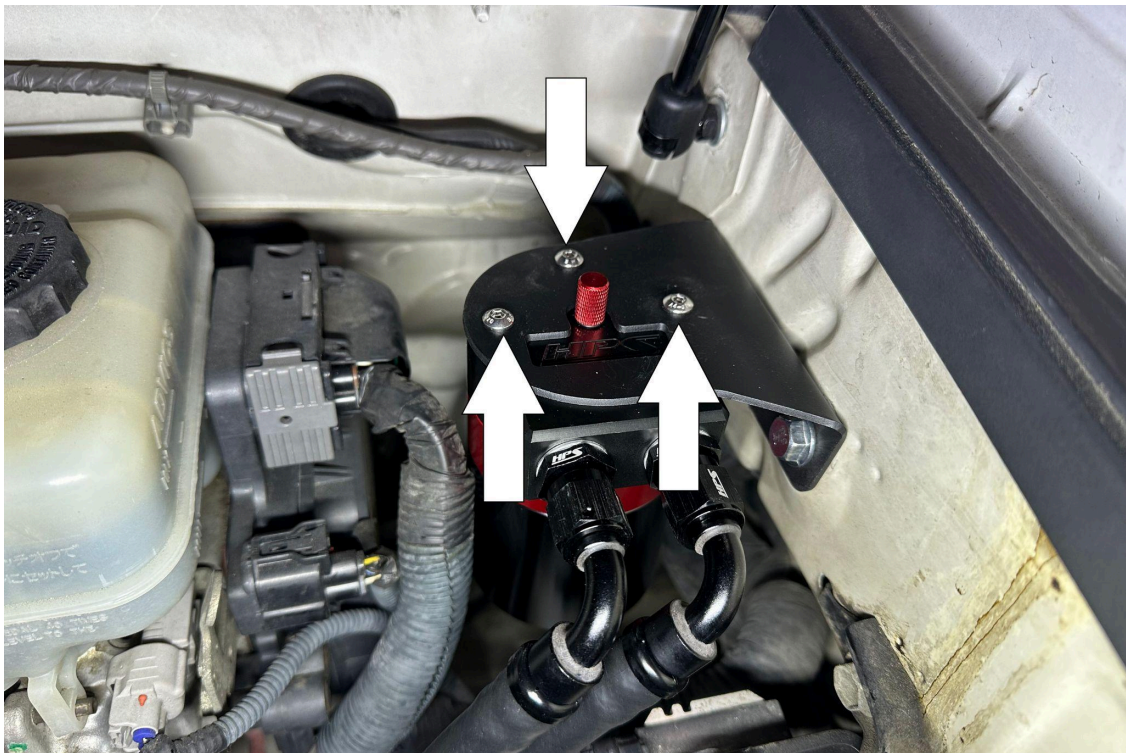

8. Secure the oil catch can onto the oil catch can bracket using the three provided M5 bolts.

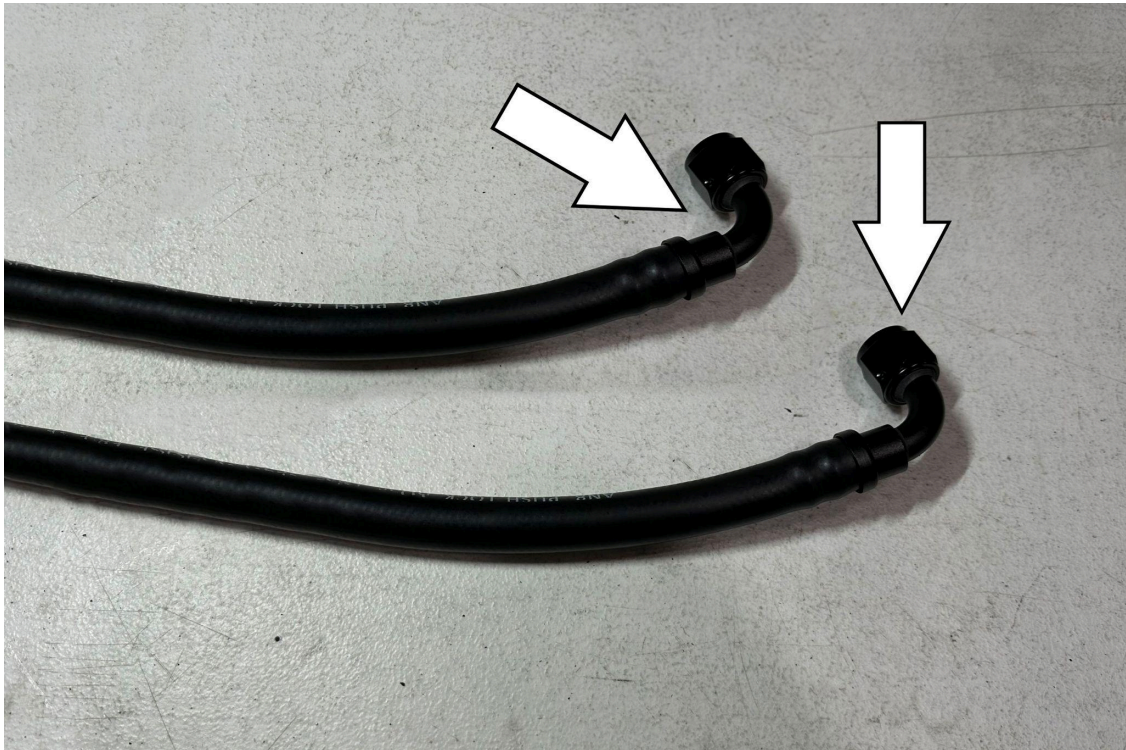

9. Install a AN-6 90 degree hose end fitting onto one end of each of the provided hoses. Depending on your vehicle's engine, the longer hose may need to be cut down to length.

IMPORTANT: VVTi and non VVTi intake barbs are located in different places and require different lengths for the longer hose.

2003-2004 non VVTi engine = no modification needed

2005-2009 VVTi engine = cut longer hose down to 30 inches

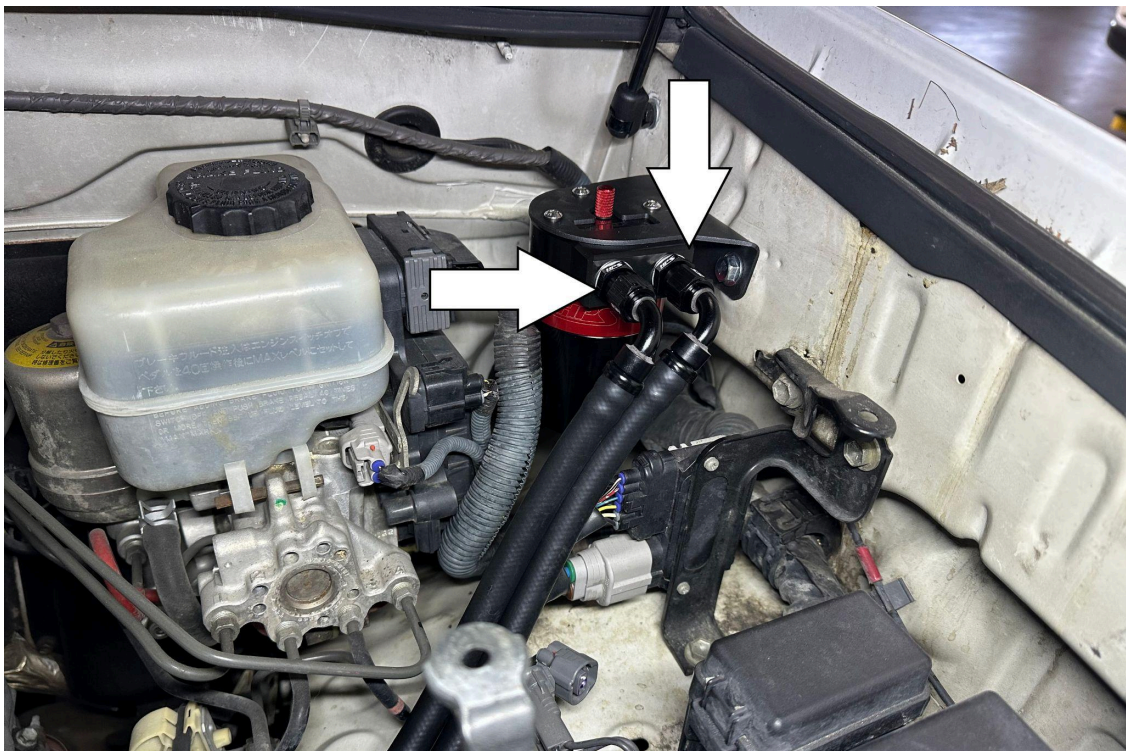

10. Fasten the longer hose to the adapter closest to the inner fender. Next, fasten the shorter hose to the adapter closest to the brake master cylinder.



11. Install the opposite end of the shorter hose to the PCV barb.

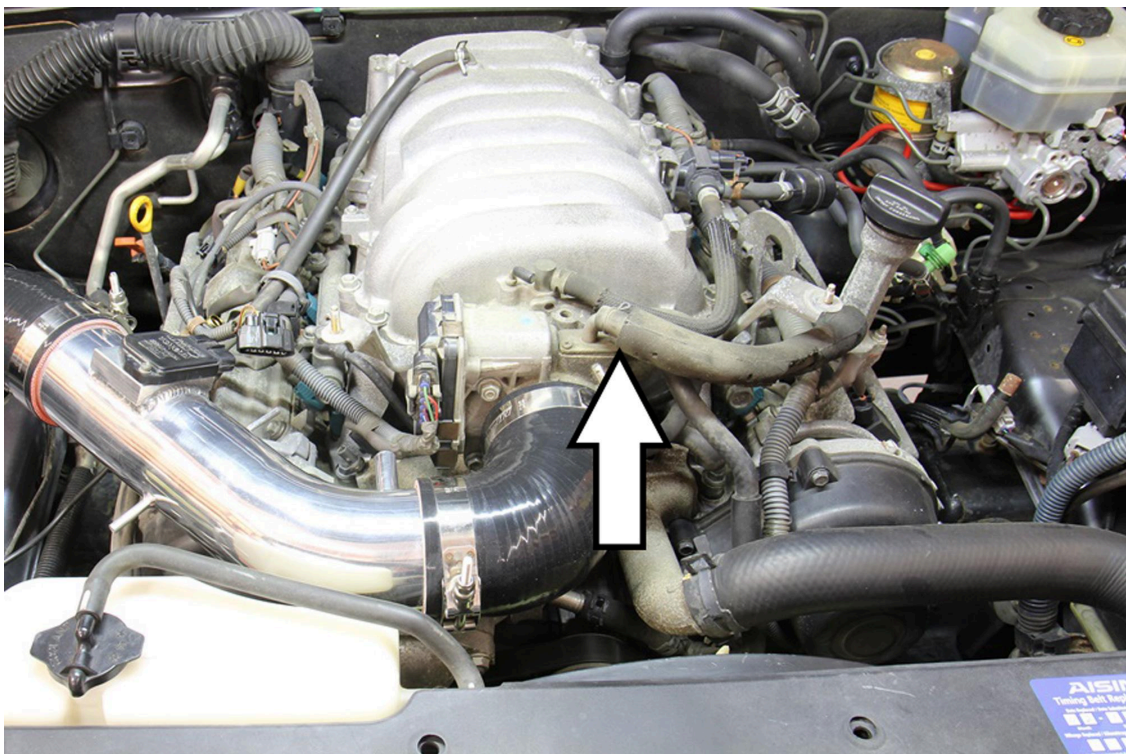

12a. 2003-2004 non VVTi engine vehicles ONLY

Press the opposite end of the longer hose onto the intake barb indicated in the picture above



12b. 2005-2009 VVTi engine vehicles ONLY

Press the opposite end of the longer hose onto the intake barb indicated in the picture above.

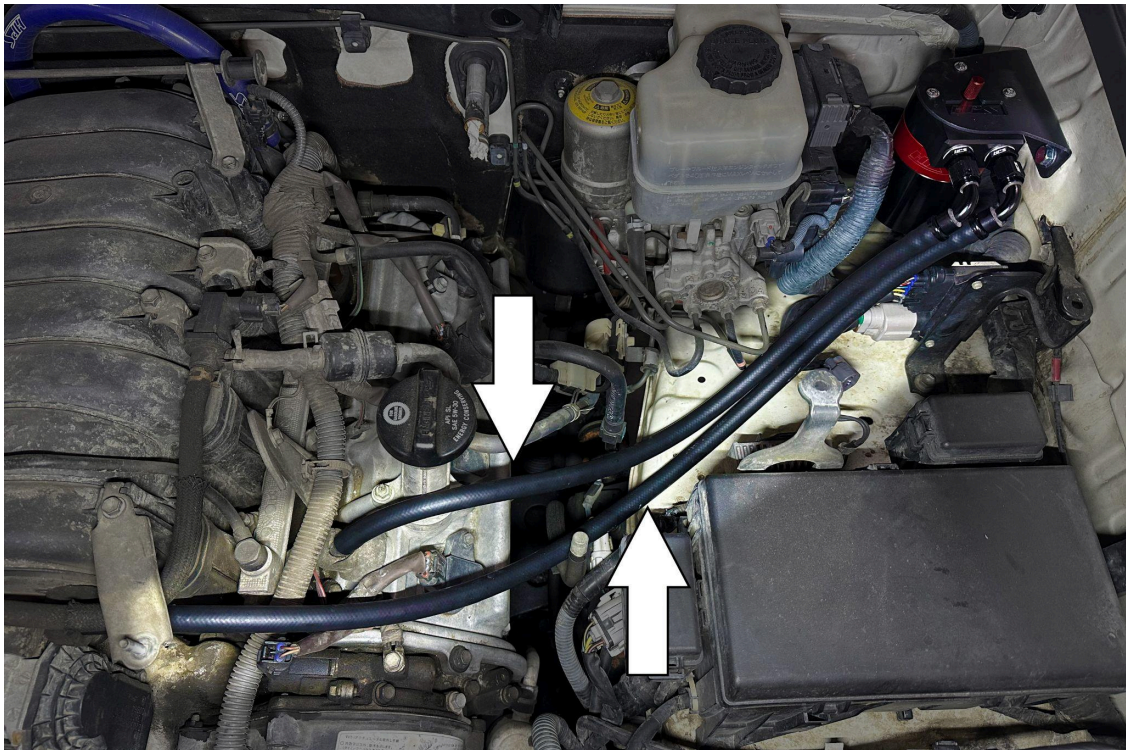

13. Position the hoses as shown in the picture above.



14. Reinstall the engine cover.

FINAL STEPS

Upon completion of the installation, reconnect the negative battery terminal before you start the engine. Double check to make sure everything is tight and properly positioned before starting the vehicle.

Start the engine. Let the car idle for 3 minutes. Perform a final inspection before driving. Listen carefully for any odd noises or rattles prior to taking it for a test drive. If any problems arise, go back and check the hoses and clamps that may be causing the issue and correct the problem.

Ensure that the dipstick on the HPS oil catch can is fully seated. Failure to install the dipstick properly will result in a check engine light and poor performance.



**Also available for:
2003-2009 Lexus GX470 4.7L V8**



**HPS Performance Air Intake Kit
For 2003-2004 GX470
Part Number [827-618](#)**



**HPS Performance Air Intake Kit
For 2005-2009 GX470
Part Number [827-730](#)**



**HPS Silicone Radiator + Heater Hose Kit
Part Number [57-1467](#)**



**HPS Stainless Steel Magnetic Oil Drain Plug
Part Number [MDP-M12x125](#)**

Contact an authorized HPS Performance dealer or
visit us at hpsperformance.com for more details